



Sharing with Google Classroom

Planet eStream customers who also use Google Classroom can share content from Planet eStream via Google Classroom by following the simple steps below.

Step One

Locate the item that you wish to share and click the **Share** button followed by **Share by Web Link**.

The screenshot displays the Planet eStream user interface. At the top, there is a navigation bar with the Planet eStream logo, a search bar, and icons for Categories, View, Create, and Tools. The main content area shows a video player on the left and a details panel on the right. The details panel is for a video titled "The Secret Science of Pop". It includes a star rating, a public status, and a "Share" button. The "Share" button is highlighted with a red box, and a dropdown menu is visible below it, showing "Share by Web Link" and "Share by Embedding". Other options in the menu include "Add to", "Edit Details", "Tag Students", "Item Stats", "Edit Video", "Select Quiz", "Manage Subtitles", "Delete", "Re-download from Connect", and "Help". The description of the video is: "Professor Armand Leroi, an evolutionary biologist, explores the 'scientific history of pop music' and attempts to use the data to create a hit record with producer Trevor Horn. Also in HD. [AD.S]". Below the description, there are fields for Broadcast Date (24/07/2017 21:00) and Broadcast Channel (BBC Four).

Step Two

Click on the **Google Classroom** button.

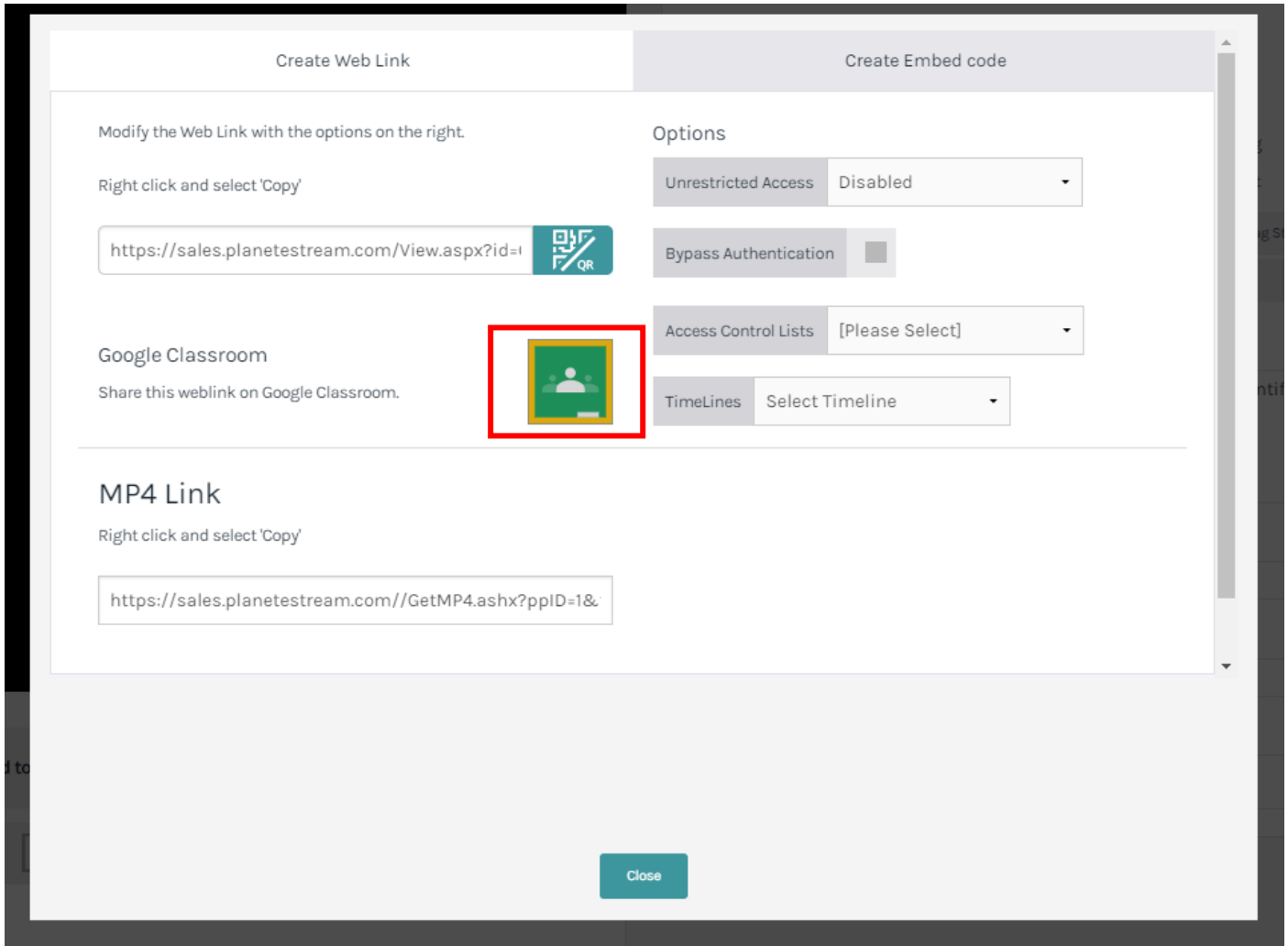

Step Three

Log into Google Classroom if not logged in already and choose the class you wish to share to

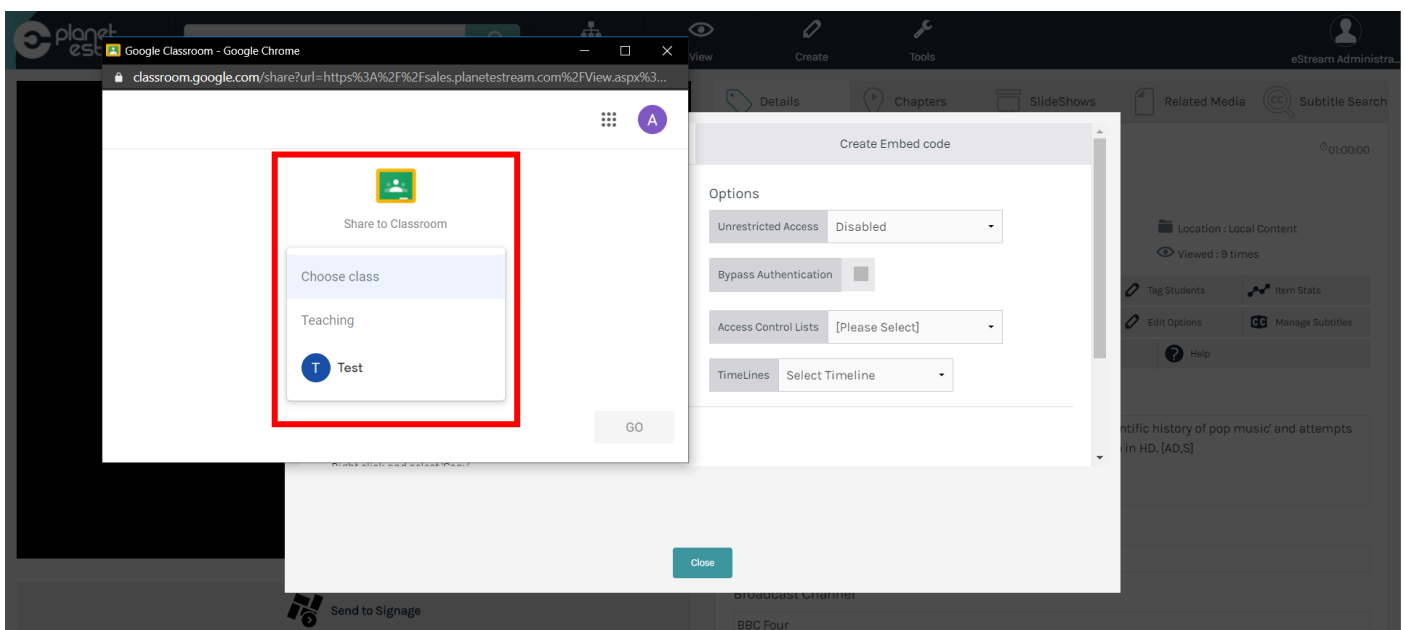

Step Four

Choose an action from the drop-down, for example 'Make an Announcement' and then click **Go**.

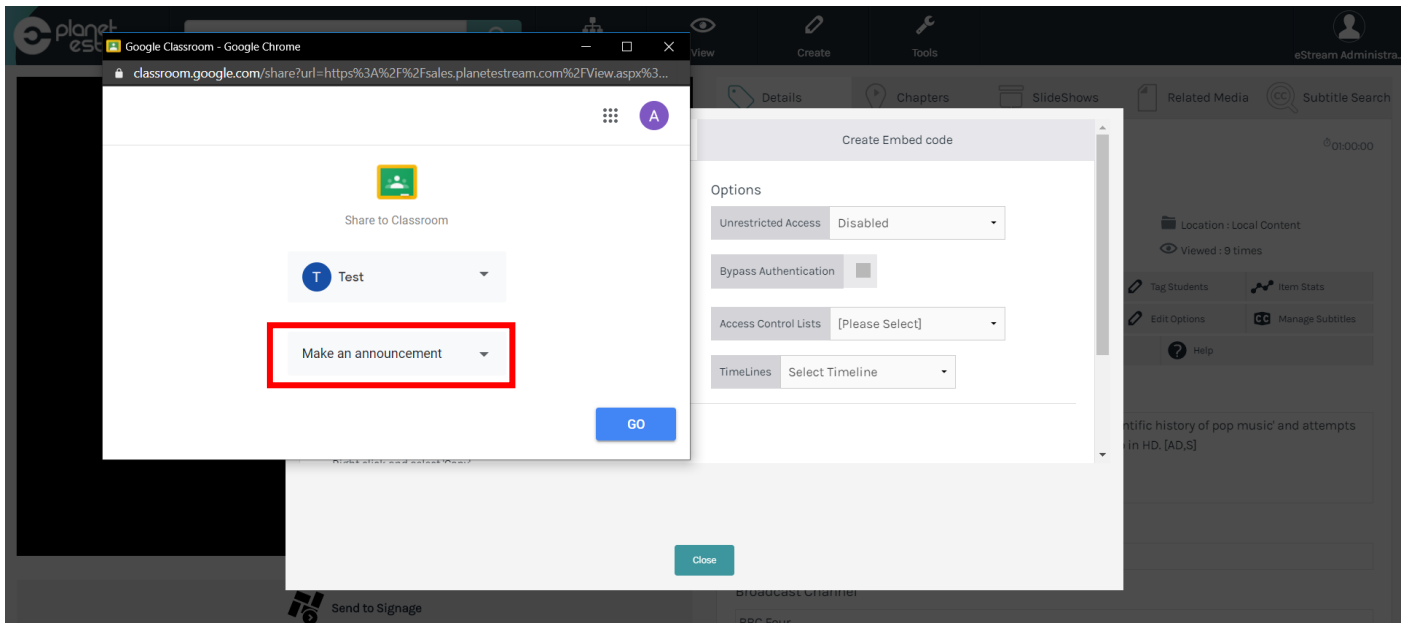

Step Five

Add any additional instructions if you want to, you can also modify any task specific information, such as due date for assignments, on the right-hand side.

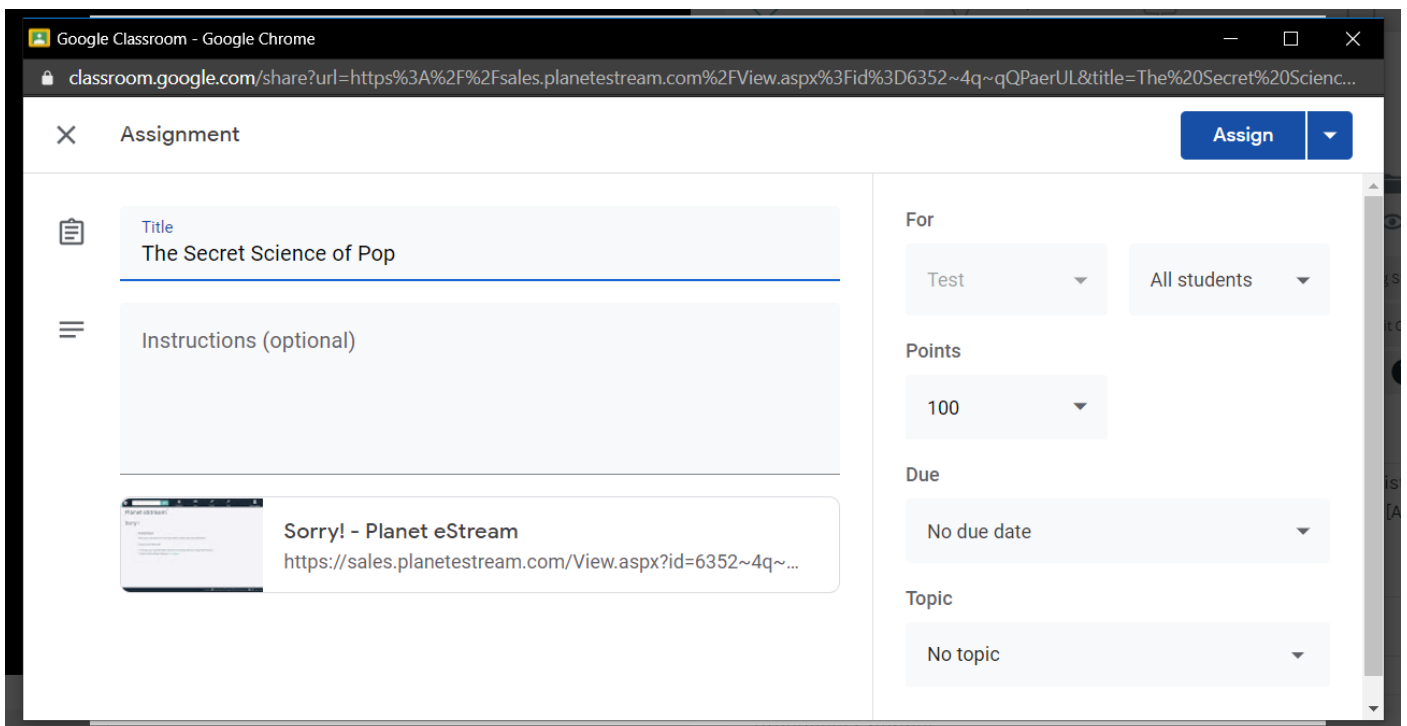

Step Six

Click Assign to add the link to Google Classroom.

